

PLAT OF SURVEY

OF
LOT 5-D IN CANTERBURY CORNERS SUBDIVISION, A RESUBDIVISION OF LOT 5 OF THE COMMONS
SUBDIVISION, BEING A SUBDIVISION IN THE NORTHWEST 1/4 OF SECTION 15, TOWNSHIP 37
NORTH, RANGE 10 EAST OF THE THIRD PRINCIPAL MERIDIAN, ACCORDING TO THE PLAT THEREOF
RECORDED SEPTEMBER 19, 1979 AS DOCUMENT R79-34782, IN WILL COUNTY, ILLINOIS.

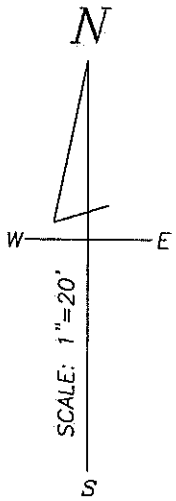

TOWN CENTRE
PARC CONDOMINIUMS
7TH ADDITION

TOWN CENTRE
PARC CONDOMINIUMS
8TH ADDITION

FENCE
0.15 N.
0.35 E.

FENCE
1.60 N.
1.30 E.

METAL FENCE

10' EASEMENT FOR UTILITIES & DRAINAGE 205.00 N 89°25'0" E

5C

LOT 5D

NO BUILDINGS EXIST
AT TIME OF SURVEY

TOWN CENTRE
PARC CONDOMINIUMS
10TH ADDITION

TOWN CENTRE
PARC CONDOMINIUMS
11TH ADDITION

TOWN CENTRE
PARC CONDOMINIUMS
15TH ADDITION

N 0°0'5" E
320.00

320.00
S 0°0'5" W

10' EASEMENT FOR UTILITIES & DRAINAGE

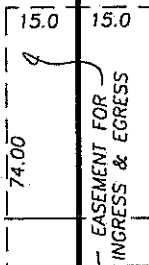

30' BUILDING LINE

20' EASEMENT FOR UTILITIES & DRAINAGE
205.00 S 89°25'0" W

FENCE
0.60 W.

CONCRETE SIDEWALK

CROSS
NOTCH
2.00 S.

50.00

ASPHALT ROAD W/ CURB & GUTTER

— — — — — HLY CACHE — — — — — LANE — — — — —

ORDERED BY:

JOHN G. STANEK, ATTY.

ORDER NO. 16 J 37

FILE NO. 16879

STATE OF ILLINOIS } s. s.



PLAT OF SURVEY

OF
LOT 5-C IN CANTERBURY CORNERS SUBDIVISION, A RESUBDIVISION OF LOT 5 OF THE COMMONS
SUBDIVISION, BEING A SUBDIVISION IN THE NORTHWEST 1/4 OF SECTION 15, TOWNSHIP 37
NORTH, RANGE 10 EAST OF THE THIRD PRINCIPAL MERIDIAN, ACCORDING TO THE PLAT THEREOF
RECORDED SEPTEMBER 19, 1979 AS DOCUMENT R79-34782, IN WILL COUNTY, ILLINOIS.

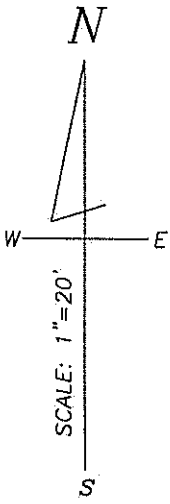

DUNHILL ESTATES

TOWN CENTRE
PARC CONDOMINIUMS
7TH ADDITION

FENCE
0.15' N.
0.35' E.

METAL FENCE

N 89°25'0" E

10' EASEMENT FOR UTILITIES & DRAINAGE 200.00

5A

LOT 5C

5D

NO BUILDINGS EXIST
AT TIME OF SURVEY

10' EASEMENT FOR UTILITIES & DRAINAGE
320.00
N 0°0'15" E

320.00
S 0°0'5" W

5B

140.00

15.0 15.0

EASEMENT FOR
INGRESS & EGRESS

74.00

30' BUILDING LINE

20' EASEMENT FOR UTILITIES & DRAINAGE

200.00

S 89°25'0" W

CONCRETE SIDEWALK

CROSS
NOTCH
2.00 S.

CROSS
NOTCH
2.00 S.

50.00

ASPHALT ROAD W/ CURB & GUTTER

HLY-CACHE LANE

ORDERED BY:

JOHN G. STANEK, ATTY.

ORDER NO. 16 J 37

FILE NO. 16879

STATE OF ILLINOIS } s. s.

