

STRAUSS

REALTY, LTD.

4700 N. RACINE AVE.
CHICAGO, IL 60640

±1,800 SF SPACE AVAILABLE IN NEWLY REHABBED BUILDING



Storefront in a multi-million dollar rehab of mixed-use building in the heart of Sheridan Park (Uptown). Currently a coin laundry (closed) but has fire-rated chase to roof (for Black Iron). Great opportunity for a café or other restaurant with huge sidewalk seating potential.



Lease Rate: \$24/PSF
Lease Type: GROSS
Size: 1,800 SF
Zoning: B3-3

**CALL FOR MORE
INFORMATION!**

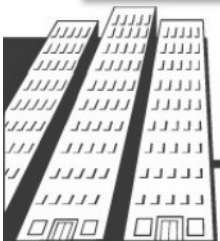

PATRICK DUFFY
773-736-3600
DUFFY@STRAUSSREALTY.COM

STRAUSS REALTY, LTD.
4220 W. MONTROSE AVENUE
CHICAGO, ILLINOIS 60641
PHONE: 773-736-3600

STRAUSS

REALTY, LTD.

4700 N. RACINE AVE.
CHICAGO, IL 60640

CAFÉ PLAN

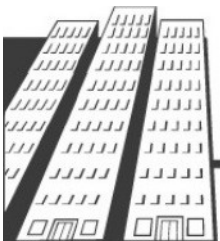
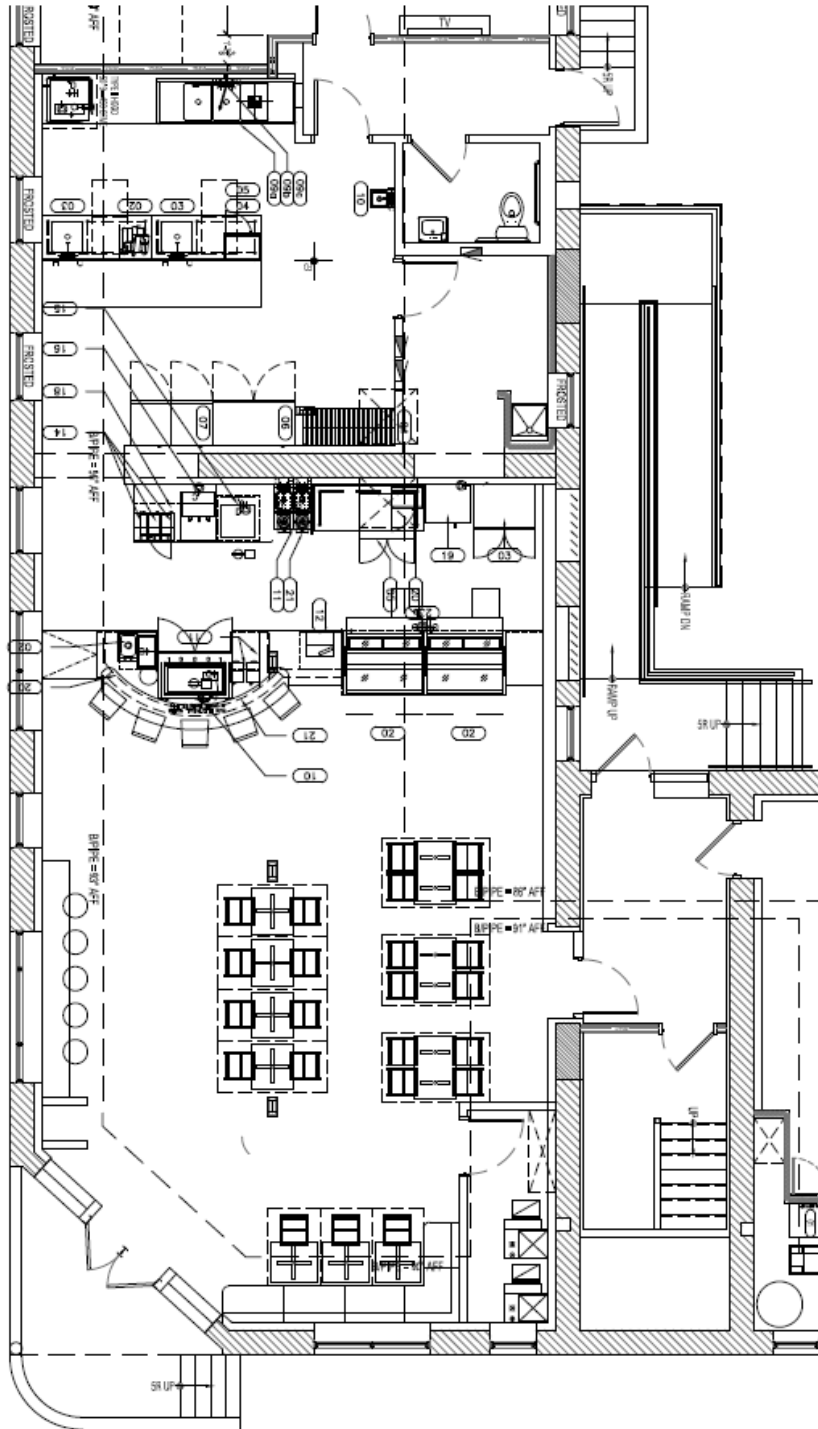

PATRICK DUFFY
773-736-3600
DUFFY@STRAUSSREALTY.COM

STRAUSS REALTY, LTD.
4220 W. MONTROSE AVENUE
CHICAGO, ILLINOIS 60641
PHONE: 773-736-3600